

8"

180 SX140



CARATTERISTICHE IDRAULICHE - HYDRAULIC PERFORMANCES

Q= Portata - Capacity - Debit **50 Hz n= 2900 min**

| Tipo Type | Power | | H(m) | 0 | 1600 | 1800 | 2000 | 2200 | 2400 | 2600 | 2800 | 3000 | 3200 | |
|---------------|-------|------|------|-------------------|-------|-------|-------|-------|-------|-------|-------|-------|-------|-------|
| | kW | HP | | l/min | l/sec | l/min | l/min | l/min | l/min | l/min | l/min | l/min | l/min | l/min |
| | | | | m ³ /h | 0 | 26,67 | 30 | 33,33 | 36,67 | 40 | 43,33 | 46,67 | 50 | 53,33 |
| 180 SX 140/1 | 9,20 | 12,5 | 25 | 20 | 19 | 19 | 18 | 17 | 17 | 16 | 14 | 12 | | |
| 180 SX 140/2 | 18,50 | 25 | 50 | 40 | 39 | 38 | 36 | 35 | 33 | 31 | 28 | 24 | | |
| 180 SX 140/3 | 30 | 40 | 75 | 60 | 58 | 56 | 54 | 52 | 50 | 47 | 41 | 36 | | |
| 180 SX 140/4 | 37 | 50 | 100 | 80 | 77 | 75 | 72 | 70 | 66 | 62 | 55 | 48 | | |
| 180 SX 140/5 | 55 | 75 | 125 | 100 | 97 | 94 | 91 | 87 | 83 | 78 | 69 | 60 | | |
| 180 SX 140/6 | 55 | 75 | 150 | 120 | 116 | 113 | 109 | 104 | 100 | 93 | 83 | 72 | | |
| 180 SX 140/7 | 66 | 90 | 175 | 140 | 135 | 132 | 127 | 122 | 116 | 109 | 97 | 84 | | |
| 180 SX 140/8 | 75 | 100 | 200 | 160 | 154 | 150 | 145 | 139 | 133 | 124 | 110 | 96 | | |
| 180 SX 140/9 | 92 | 125 | 225 | 180 | 174 | 169 | 163 | 157 | 149 | 140 | 124 | 108 | | |
| 180 SX 140/10 | 110 | 150 | 250 | 200 | 193 | 188 | 181 | 174 | 166 | 155 | 138 | 120 | | |
| 180 SX 140/11 | 110 | 150 | 275 | 220 | 212 | 207 | 199 | 191 | 183 | 171 | 152 | 132 | | |
| 180 SX 140/12 | 110 | 150 | 300 | 240 | 232 | 226 | 217 | 209 | 199 | 186 | 166 | 144 | | |

DIMENSIONI D'INGOMBRO E PESI - OVERALL DIMENSIONS AND WEIGHTS

| Type | A mm Tri V 400 | B mm | C mm Tri | M Kg Tri | P Kg |
|---------------|-------------------|------|----------|----------|------|
| 180 SX 140/1 | 1301 | 550 | 751 | 60 | 20 |
| 180 SX 140/2 | 1691 | 700 | 991 | 83 | 28 |
| 180 SX 140/3 | 2101 | 850 | 1251 | 108 | 35 |
| 180 SX 140/4 | 2341 | 1000 | 1341 | 118 | 43 |
| 180 SX 140/5 | 2383 | 1150 | 1233 | 200 | 50 |
| 180 SX 140/6 | 2533 | 1300 | 1233 | 200 | 58 |
| 180 SX 140/7 | 2753 | 1450 | 1303 | 214 | 65 |
| 180 SX 140/8 | 2983 | 1600 | 1383 | 230 | 73 |
| 180 SX 140/9 | 3333 | 1750 | 1583 | 270 | 80 |
| 180 SX 140/10 | 3633 | 1900 | 1733 | 300 | 88 |
| 180 SX 140/11 | 3783 | 2050 | 1733 | 300 | 95 |
| 180 SX 140/12 | 3933 | 2200 | 1733 | 300 | 103 |

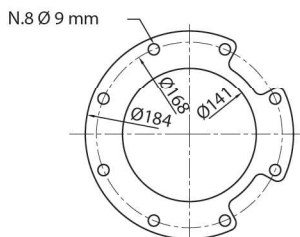
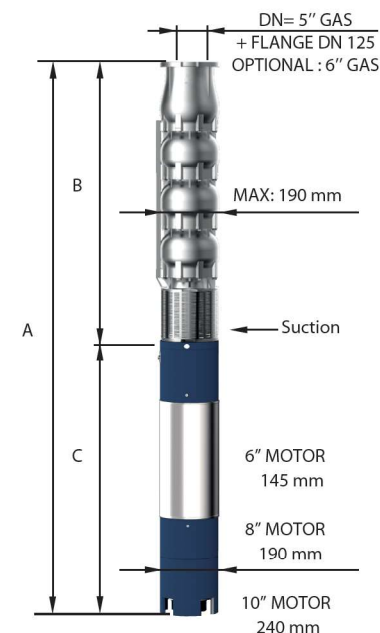

FOR COMMERCIAL TUBE
EXTERNAL DIAMETER: 139,7 mm

n% = Rendimento della pompa
n% = Rendement de la pompe
n% = Pump efficiency
n% = Rendimiento de la bomba

**Max
78,5%**

kW/st = Assorbimento per stadio
kW/st = Absorption par étage
kW/st = Stage absorption
kW/st = Potencia absorbida por etapa

**Max
9,4**

Tolleranza alla sabbia 50 g/m³ - Sand tolerance 50 g/m³ - Compatibilità con acqua potabile DM 174 Drinking water compatibility according to DM 174
Tolleranze secondo UNI ISO 9906 livello 3B - Tolerances according to UNI ISO 9906 grade 3B



8"

180 SX140

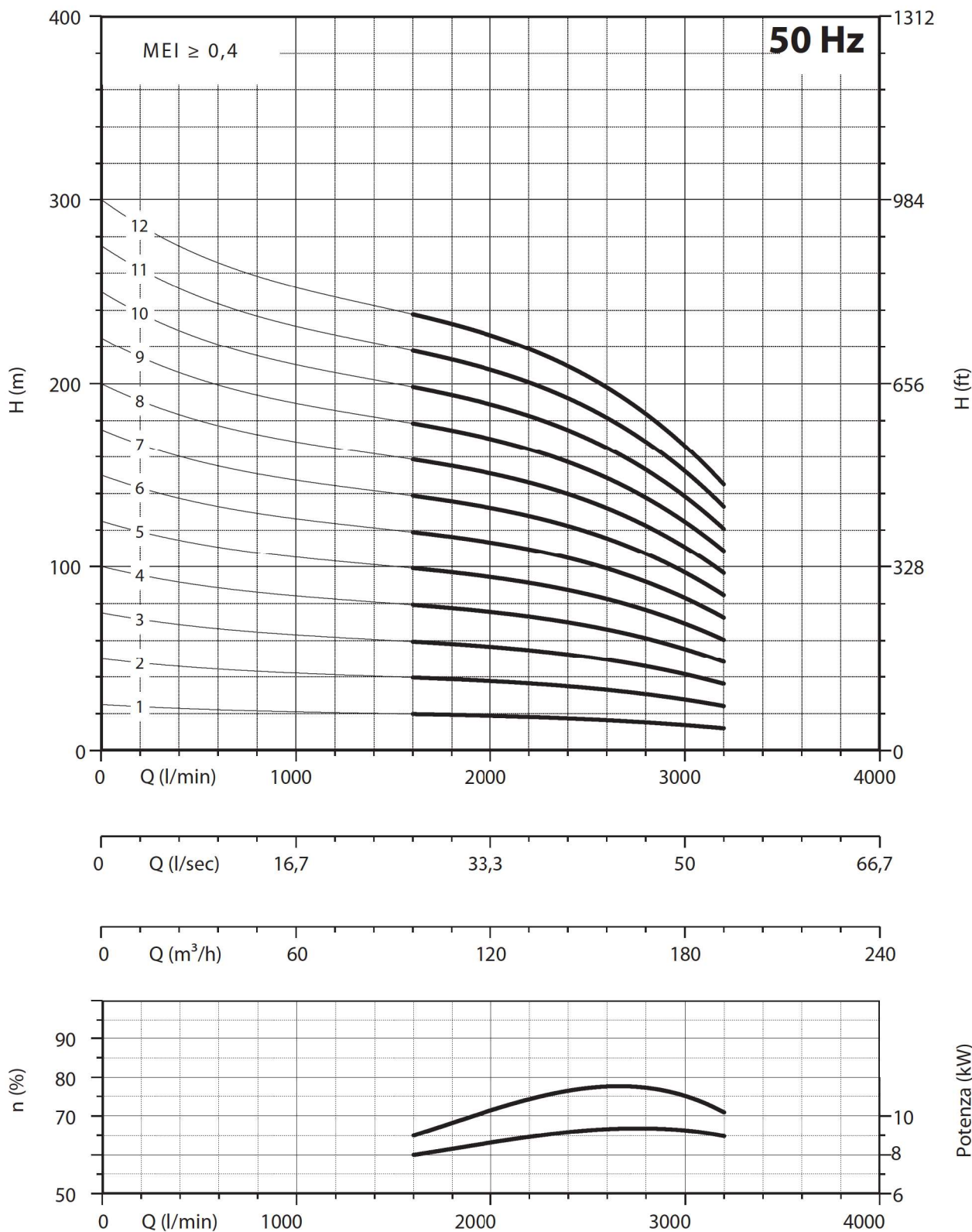

| NPSH (m) | 25% | 50% | 75% | 100% |
|------------|-----|-----|-----|------|
| 180 SX 140 | 4 | 4,5 | 7 | 13 |