

8"

180 SX124



CARATTERISTICHE IDRAULICHE - HYDRAULIC PERFORMANCES

Q= Portata - Capacity - Debit **50 Hz n= 2900 min**

Tipo Type	Power		H(m)	l/min	1200	1400	1600	1800	2000	2200	2400	2600	2800	
	kW	HP		l/sec	0	20	23,33	26,67	30	33,33	36,67	40	43,33	46,67
				m ³ /h	0	72	84	96	108	120	132	144	156	168
180 SX 124/1	9,20	12,5	27	23	22	21	20	19	18	16	15	12		
180 SX 124/2	18,50	25	54	45	43	41	40	38	36	33	29	24		
180 SX 124/3	26	35	81	68	65	62	59	57	54	49	44	36		
180 SX 124/4	37	50	108	90	86	83	79	76	72	66	58	48		
180 SX 124/5	44	60	135	113	108	104	99	95	90	82	73	60		
180 SX 124/6	55	75	162	135	129	124	119	114	108	98	87	72		
180 SX 124/7	66	90	189	158	151	145	139	133	126	115	102	84		
180 SX 124/8	66	90	216	180	172	166	158	152	144	131	116	96		
180 SX 124/9	75	100	243	203	194	186	178	171	162	148	131	108		
180 SX 124/10	92	125	270	225	215	207	198	190	180	164	145	120		
180 SX 124/11	92	125	297	248	237	228	218	209	198	180	160	132		
180 SX 124/12	110	150	324	270	258	248	238	228	216	197	174	144		
180 SX 124/13	110	150	351	293	280	269	257	247	234	213	189	156		

DIMENSIONI D'INGOMBRO E PESI - OVERALL DIMENSIONS AND WEIGHTS

Type	A mm Tri V 400	B mm	C mm Tri	M Kg Tri	P Kg
180 SX 124/1	1276	525	751	60	20
180 SX 124/2	1641	650	991	83	27
180 SX 124/3	1956	775	1181	100	34
180 SX 124/4	2241	900	1341	118	41
180 SX 124/5	2148	1025	1123	178	48
180 SX 124/6	2383	1150	1233	200	55
180 SX 124/7	2578	1275	1303	214	62
180 SX 124/8	2703	1400	1303	214	69
180 SX 124/9	2908	1525	1383	230	76
180 SX 124/10	3233	1650	1583	270	83
180 SX 124/11	3358	1775	1583	270	90
180 SX 124/12	3633	1900	1733	300	97
180 SX 124/13	3758	2025	1733	300	104

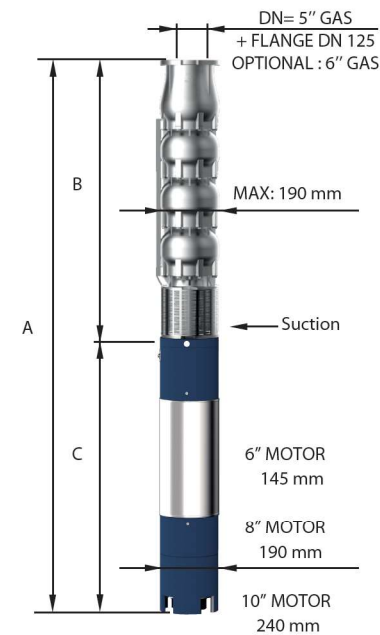

N.8 Ø9 mm

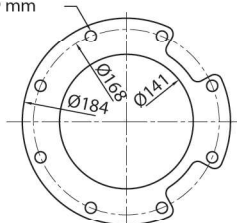

FOR COMMERCIAL TUBE
EXTERNAL DIAMETER: 139,7 mm

n% = Rendimento della pompa
n% = Rendement de la pompe
n% = Pump efficiency
n% = Rendimiento de la bomba

**Max
78%**

kW/st = Assorbimento per stadio
kW/st = Absorption par étage
kW/st = Stage absorption
kW/st = Potencia absorbida por etapa

**Max
8,4**

Tolleranza alla sabbia 50 g/m³ - Sand tolerance 50 g/m³ - Compatibilità con acqua potabile DM 174 Drinking water compatibility according to DM 174
Tolleranze secondo UNI ISO 9906 livello 3B - Tolerances according to UNI ISO 9906 grade 3B



8"

180 SX124

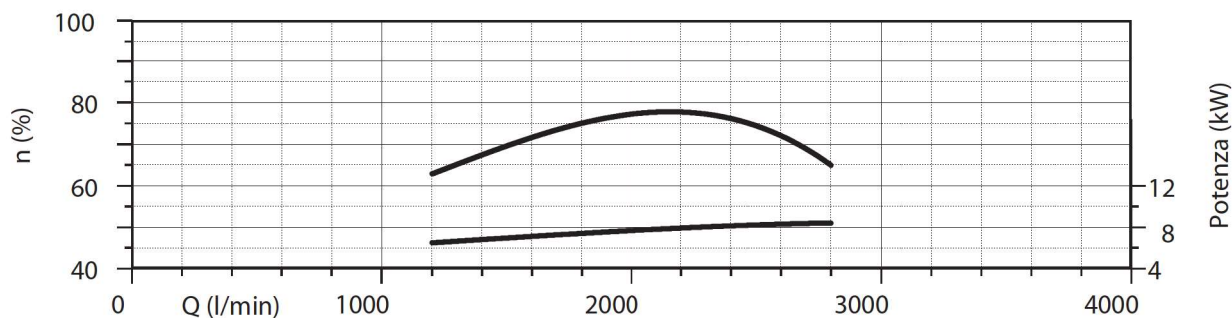
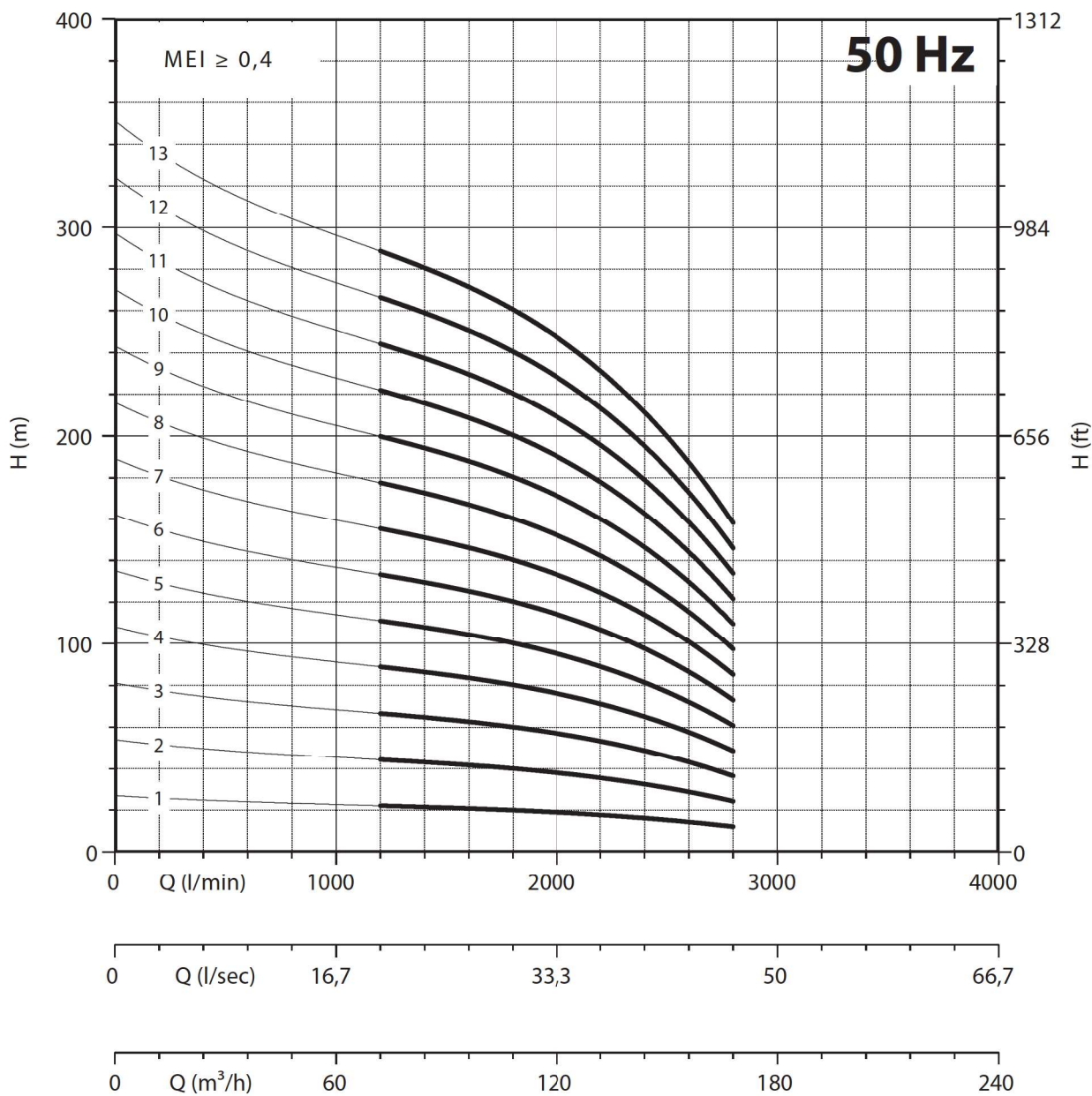

NPSH (m)	25%	50%	75%	100%
180 SX124	2,5	3	3,5	8,7