

8"

180 SX78



CARATTERISTICHE IDRAULICHE - HYDRAULIC PERFORMANCES

Q= Portata - Capacity - Debit **50 Hz n= 2900 min**

Tipo Type	Power		H(m)	l/min	600	800	1000	1200	1400	1600
	kW	HP		l/sec	10	13,33	16,67	20	23,33	26,67
				m ³ /h	36	48	60	72	84	96
180 SX 78 /01	7,50	10	27	24	23	22	20	18	15	
180 SX 78 /02	11	15	54	49	47	44	40	35	30	
180 SX 78 /03	18,50	25	81	73	70	65	60	53	44	
180 SX 78 /04	26	35	108	97	93	87	80	70	59	
180 SX 78 /05	30	40	135	121	116	109	100	88	74	
180 SX 78 /06	37	50	162	146	140	131	120	105	89	
180 SX 78 /07	44	60	189	170	163	152	140	123	103	
180 SX 78 /08	55	75	216	194	186	174	160	140	118	
180 SX 78 /09	55	75	243	218	209	196	180	158	133	
180 SX 78 /10	66	90	270	243	233	218	200	175	148	
180 SX 78 /11	66	90	297	267	256	239	220	193	162	
180 SX 78 /12	75	100	324	291	279	261	240	210	177	
180 SX 78 /13	75	100	351	315	302	283	260	228	192	
180 SX 78 /14	92	125	378	340	326	305	280	245	207	
180 SX 78 /15	92	125	405	364	349	326	300	263	221	
180 SX 78 /16	92	125	432	388	372	348	320	280	236	
180 SX 78 /17	110	150	459	412	395	370	340	298	251	
180 SX 78 /18	110	150	486	437	419	392	360	315	266	
180 SX 78 /19	110	150	513	461	442	413	380	333	280	

DIMENSIONI D'INGOMBRO E PESI - OVERALL DIMENSIONS AND WEIGHTS

Type	A mm Tri V 400	B mm	C mm Tri	M Kg Tri	P Kg
180 SX 78 /01	1226	525	701	55	19
180 SX 78 /02	1461	650	811	65	26
180 SX 78 /03	1766	775	991	83	32
180 SX 78 /04	2081	900	1181	100	39
180 SX 78 /05	2276	1025	1251	108	45
180 SX 78 /06	2491	1150	1341	118	52
180 SX 78 /07	2398	1275	1123	178	58
180 SX 78 /08	2633	1400	1233	200	65
180 SX 78 /09	2758	1525	1233	200	71
180 SX 78 /10	2953	1650	1303	214	78
180 SX 78 /11	3078	1775	1303	214	84
180 SX 78 /12	3283	1900	1383	230	91
180 SX 78 /13	3408	2025	1383	230	97
180 SX 78 /14	3733	2150	1583	270	104
180 SX 78 /15	3858	2275	1583	270	110
180 SX 78 /16	3983	2400	1583	270	117
180 SX 78 /17	4258	2525	1733	300	123
180 SX 78 /18	4383	2650	1733	300	130
180 SX 78 /19	4508	2775	1733	300	136

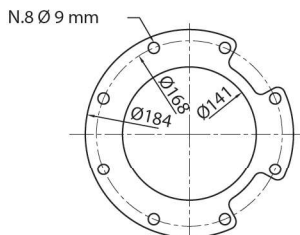
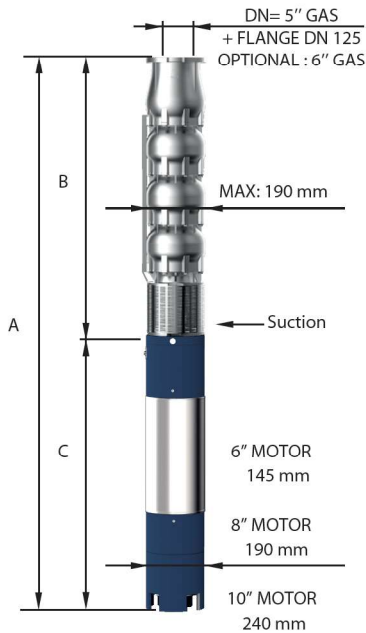

FOR COMMERCIAL TUBE
EXTERNAL DIAMETER: 139,7 mm

n% = Rendimento della pompa
n% = Rendement de la pompe
n% = Pump efficiency
n% = Rendimiento de la bomba

Max 74%

kW/st = Assorbimento per stadio
kW/st = Absorption par étage
kW/st = Stage absorption
kW/st = Potencia absorbida por etapa

Max 5,75

Tolleranza alla sabbia 50 g/m³ - Sand tolerance 50 g/m³ - Compatibilità con acqua potabile DM 174 Drinking water compatibility according to DM 174
Tolleranze secondo UNI ISO 9906 livello 3B - Tolerances according to UNI ISO 9906 grade 3B



8"

180 SX78

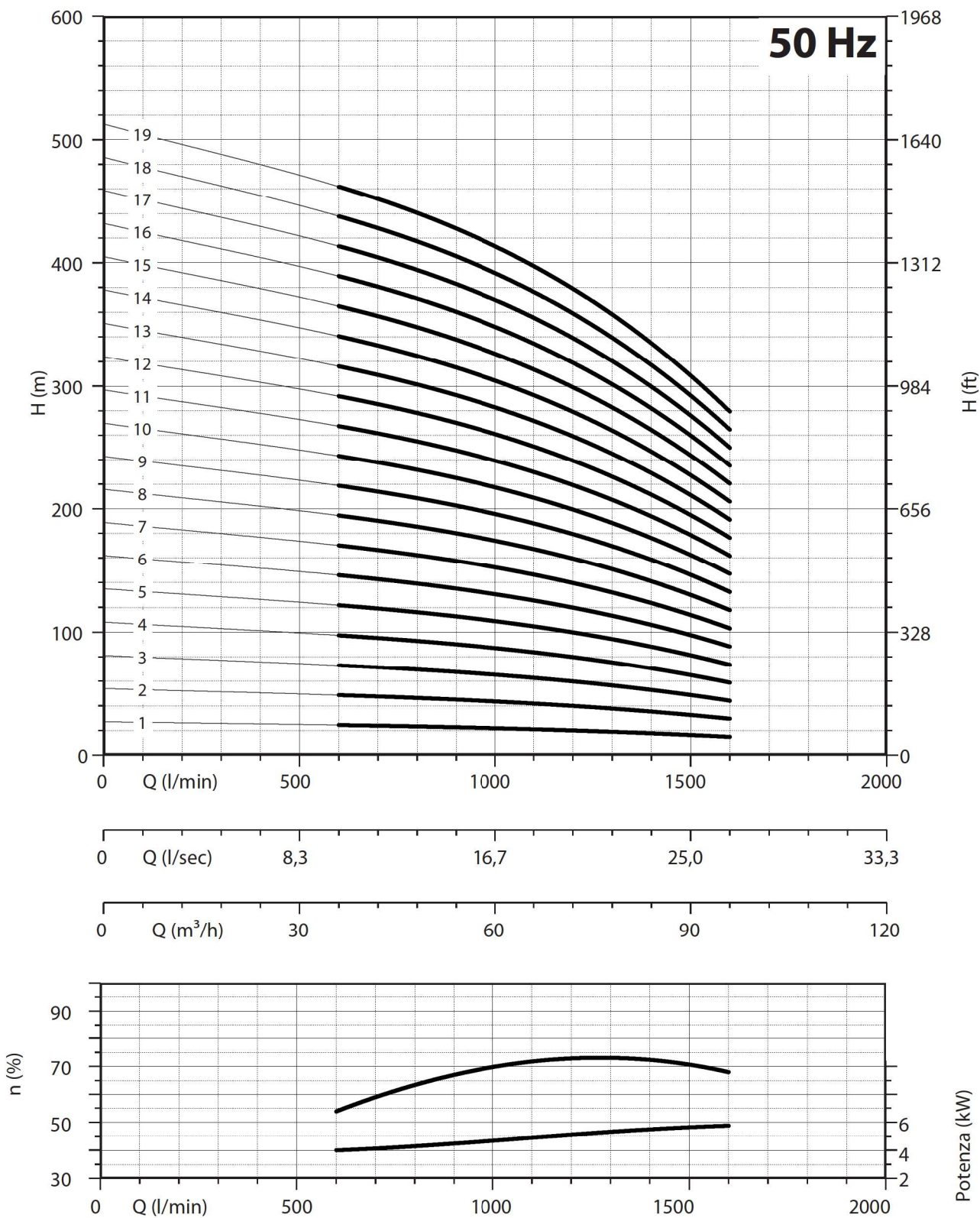

NPSH (m)	25%	50%	75%	100%
180 SX 78	3	3	3,5	4,5